

Installation Guidelines

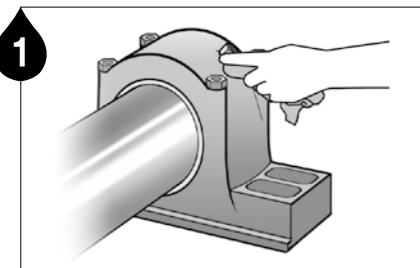

1 Remove contaminants around the lube point.

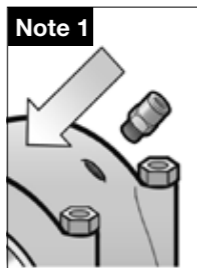

Note 1

For BSPT, install the 084333 push-in type tube fitting directly onto the lube point.



Note 2

For NPT, install the 084334 thread converter + 084333 push-in type tube fitting.

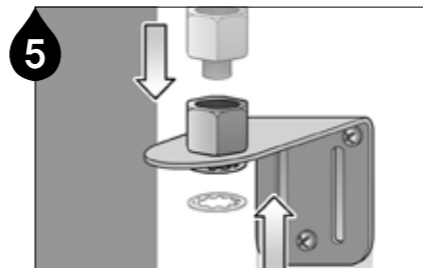

5

Install the 084329 adaptor on the fixed mounting bracket with the washer (B058) on the bottom.

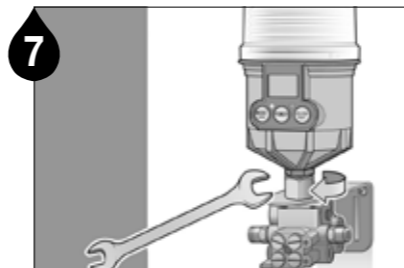

7

Install the lubricator onto the mounting bracket using a 17mm wrench.



2 Ensure a clear passage using a manual grease gun. **Note 1** Remove any hardened grease by purging the lube point with a manual grease gun. **Note 2** The grease in the equipment and the grease contained in the unit should be the same or compatible.

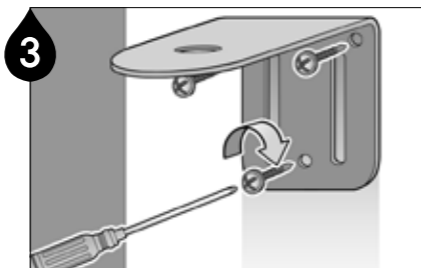

3

Install the 084326 mounting bracket at a proper location using screws (B051).

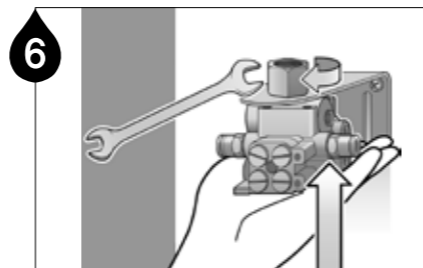

6

Connect the divider block to the adaptor, washer, and mounting bracket and turn the 084329 adaptor clockwise to tighten.

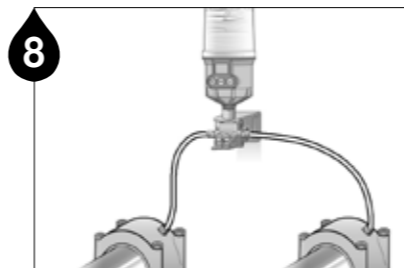

8

For typical bearing applications, install the divider block to the equipment using either copper or nylon tubes.

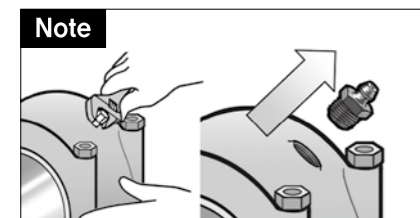

Note

Remove the grease nipple.

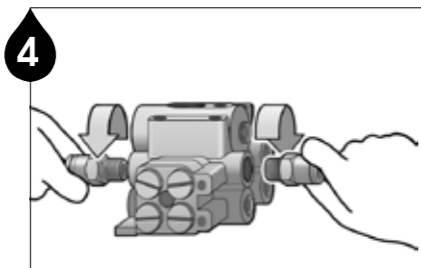

4

Screw in the 084333 push-in fitting connectors to each port of the divider block.

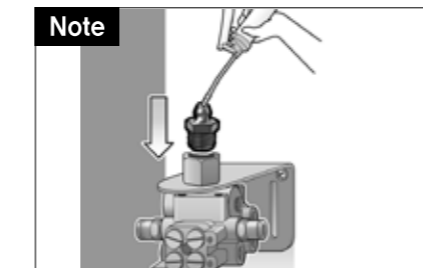

Note

Pre-fill the divider block with the same or compatible grease using a grease gun and a 3/8" grease nipple.

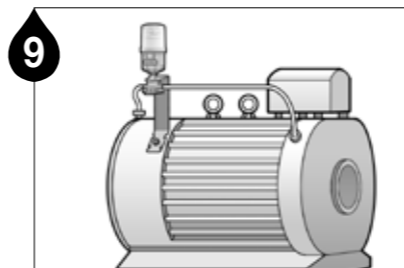

9

For motor bearing applications, install the mounting bracket at a proper location using the 2 point remote installation kit and then connect the lube-lines to both bearings.

Mounting Method

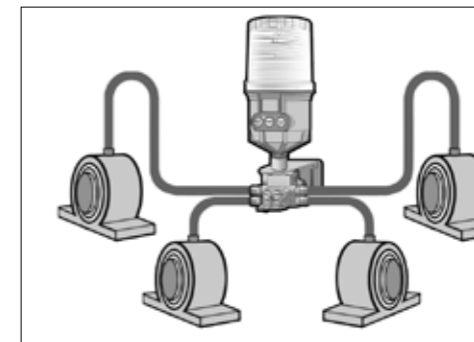

Multi-Point Installation

Remote multi-point lubrication is available with the Lubri-Cup EM using a divider block. It is recommended to test the back pressure of the bearing, lube lines, and divider block after assembly using a grease gun connected to a pressure gauge. Ensure the break-off pressure is below the average operating pressure of 30bar (435psi).

Warning

- Do not plug any open ports on the divider block. The kit or divider block must be ordered with the appropriate number of points required.
- For remote installation using a 6mm I.D. tubing, keep the maximum distance at 6m (20ft) or less.
- Prior to installation, ensure a clear passage using a manual grease gun and be sure to test the lubricator for proper operation.

Divider Block Grease Volume

Part No.	Outlet No.	Outlet No. / Grease Volume
HU - 2RS	1 / 2	
HU - 3RS	1 / ② / 5	No.2 / twice as much
HU - 4RS	1 / 2 / 5 / 6	
HU - 5RS	1 / 2 / ③ / 5 / 6	No.3 / twice as much
HU - 6RS	1 / 2 / 3 / 5 / 6 / 7	
HU - 7RS	1 / 2 / 3 / 5 / 6 / 7 / ⑧	No.8 / twice as much
HU - 8RS	1 / 2 / 3 / 4 / 5 / 6 / 7 / 8	

Note 1 The average dispensing volume of each port is about 0.3ml EXCEPT No.2 of HU-3RS, No.3 of HU-5RS, and No.8 of HU-7RS. The three ports above will dispense double the amount of grease as the other ports.

Note 2 The Outlet No. is shown near each port on the divider block.

Detailed Parts

Part No.	Component Parts and Quantities						
EM unit	Sold separately						
084329	Reducer 3/8F x 1/8M Adapter						1ea
084326	Mounting Bracket						1ea
-----	Tapping Screws (Purchase from any hardware store)						3ea
-----	Lock Washer (Purchase from any hardware store)						1ea
084333	4ea	6ea	8ea	10ea	12ea	14ea	16ea
	Tube Fitting PC6 -PT 1/8" Push in fitting						
Divider Block	2ea 085655	3ea 085656	4ea 085657	5ea 085658	6ea 085659	7ea 085661	8ea 085662
084336	1ea	2ea	2ea	3ea	3ea	4ea	4ea
	Tubing filled with 630 Grease						
084334	Component Parts and Quantities: Thread Converter (PT to NPT), PT1/8" F x NPT1/8" M (list it the way 084333 is shown)						

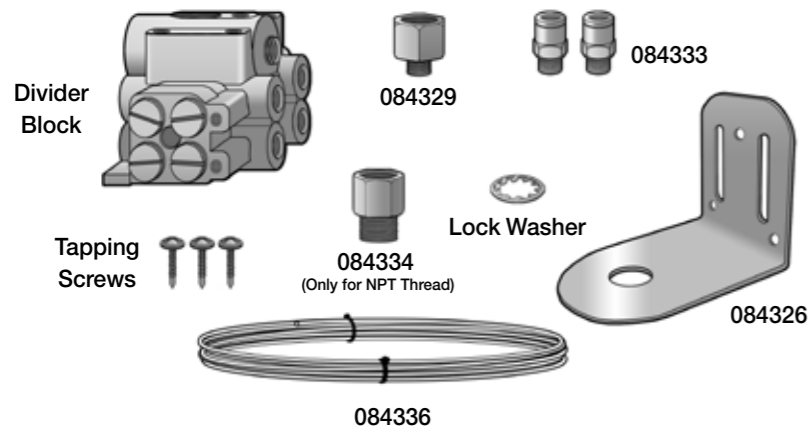

Warranty Product warranty is limited to original defects in material and workmanship and will not cover any collateral damage due to mishandling, abuse and /or any other inappropriate use of this product.



A.W. Chesterton Company
 860 Salem Street, Groveland, MA 01834, USA
 www.chesterton.com

